

HALSING

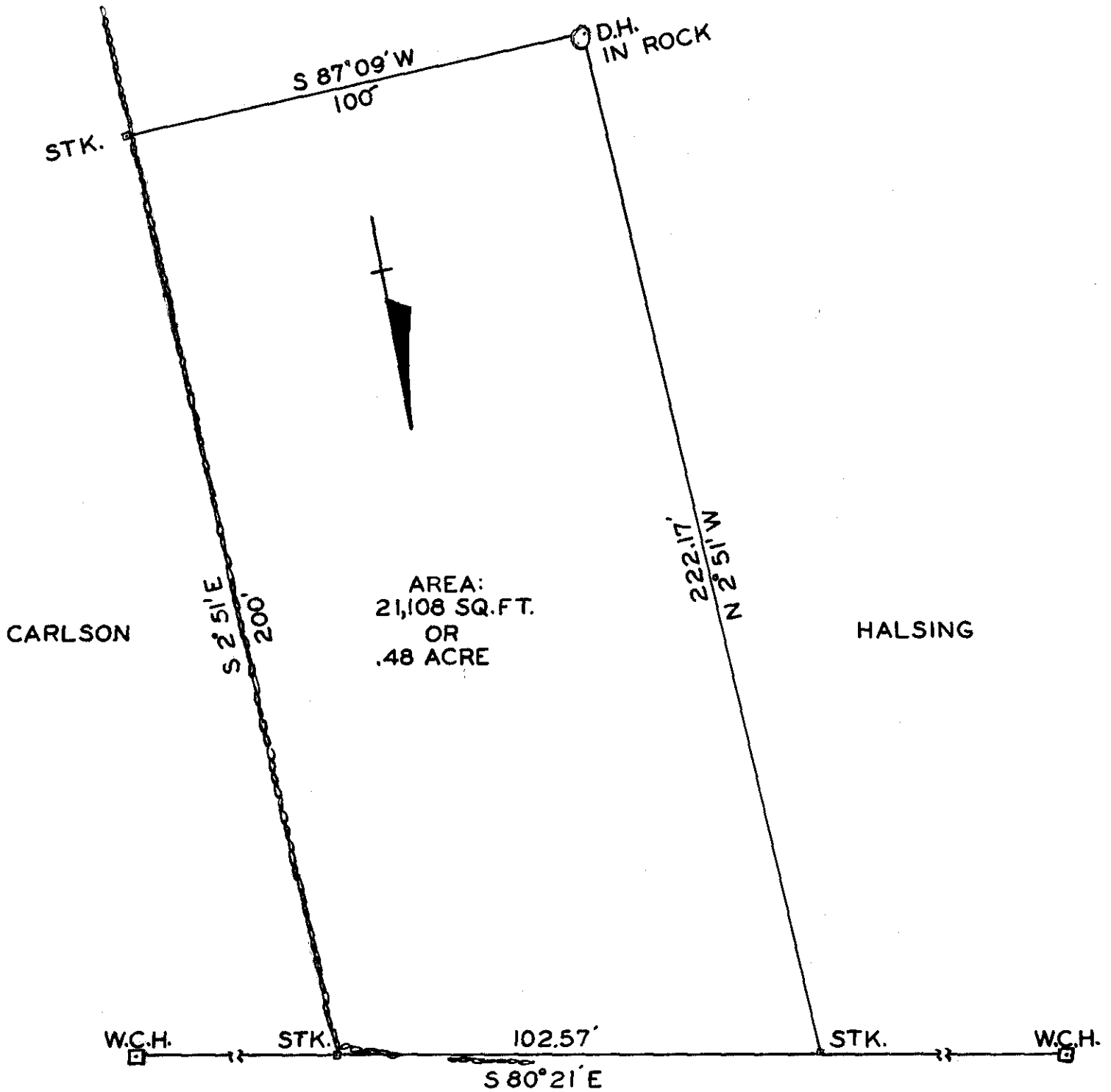

AREA:
21,108 SQ. FT.
OR
.48 ACRE

WORCESTER DISTRICT REGISTRY
OF DEEDS-RECORDER, MA
PLAN BOOK 218 PLAN 122
Received SEPT. 14, 1956
8:30 A.M.
Sheet 1 of 1

ATTEST: *Anthony J. Gault*
Register

LAND IN MENDON, MASS.
DEEDED TO
WALTER J. JR. & PATRICIA B. BUTLER
BY

GIDEON & OLGA I. HALSING

SCALE: 1" = 30'

AUG. 11, 1956

P. MAC NEVIN